

INSTRUCTIONS FOR DT013 TRIM FOR 1110MLT SERIES MORTISE EXIT DEVICE

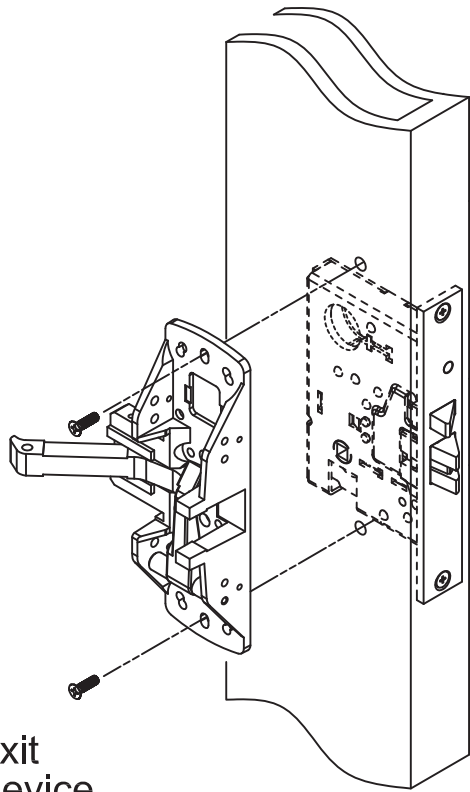
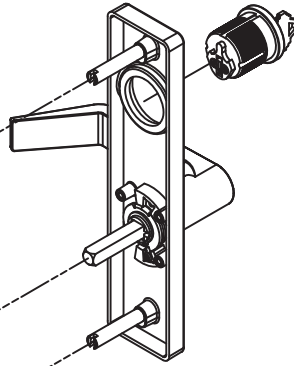
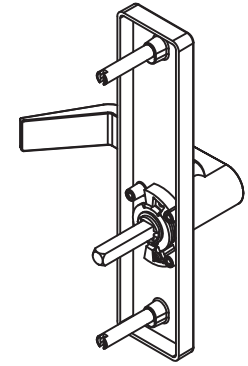
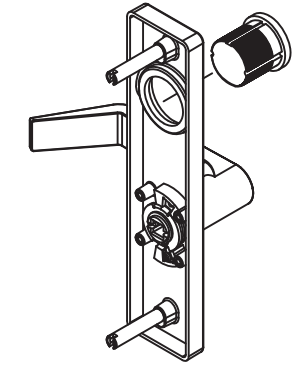
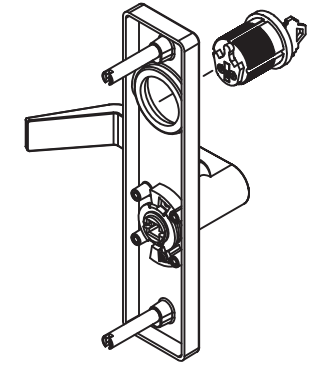

Exit
Device
Chassis

	DT013	DT013P	DT013D	DT013S
	 <p>Key locked and Unlock mortise lock Lever operate To open</p>	 <p>No Cyl Trim Always Operable</p>	 <p>Pull when Push bar locked down Dummy Lever Trim</p>	 <p>Rigid Lever, Cyl Lever Trim</p>
	Entrance	Passage	Dummy	Storeroom
	Attach the collar and mortise cyl to the case with mortise nut, attach case to door thru bolting (2) screws to the chassis, aligning spindle to hub	Attach case to door thru bolting the (2) screws to the chassis, allaning spindle to hub of the Chassis	Attach the collar and dummy cyl to the case with mortise nut, attach case to door thru bolting (2) screws to the chassis,	Attach the collar and mortise cyl to the case with mortise nut, attach case to door thru bolting (2) screws to the chassis, aligning sprindle to hub

DT013 Lever Trim For 1110MLT

Method of Changing Hand of Lever , LHR (Reverse step for RHR)

1. Lever Trim shipped and supplied with lever positioned neutral, Non-Handed

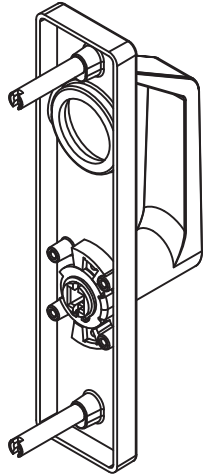

2-1. Rotate lever to desired hand, LHR, position at 90°~95°
2-2. Fasten guide stop plate to case

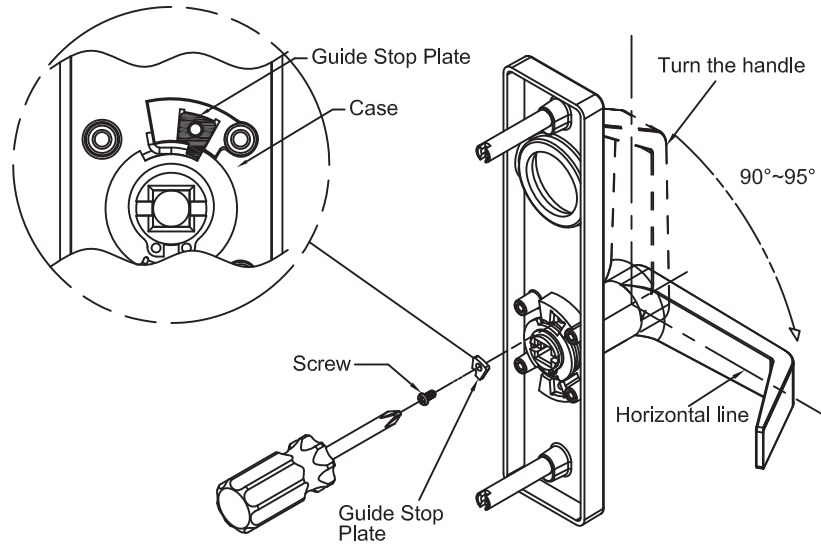

3. Done

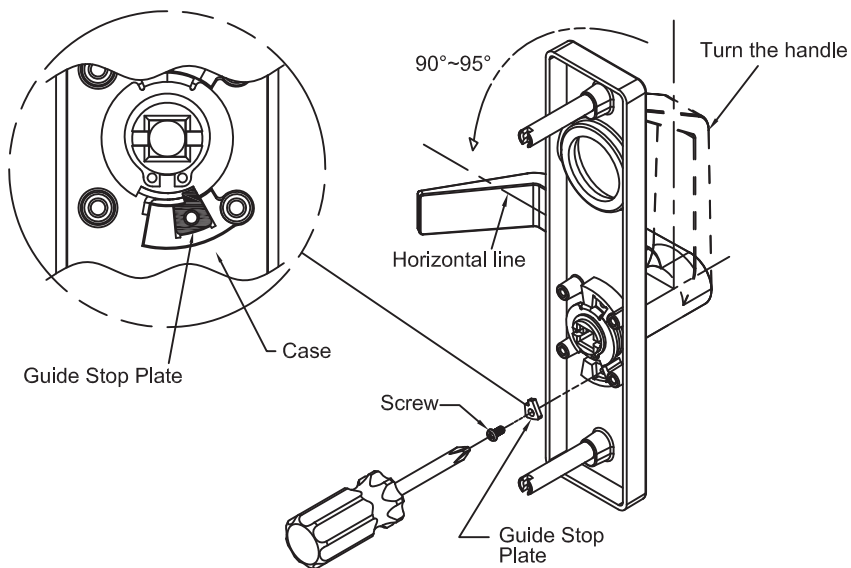
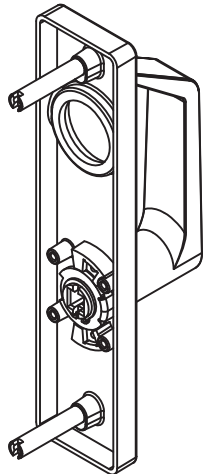
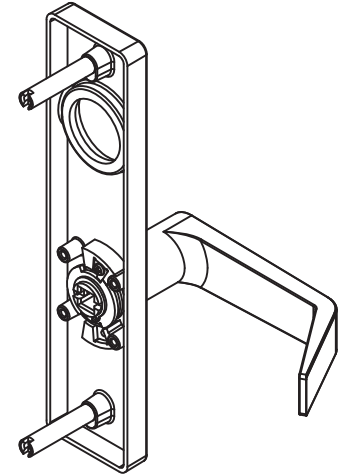

1. Lever Trim shipped and supplied with lever positioned neutral, Non-Handed

2-1. Rotate lever to desired hand, RHR, position at 90°~95°
2-2. Fasten guide stop plate to case

3. Done

