

## ITEM CODE: 1002-1202-14X SERIES

CLIP-ON CABINET HINGE, CLOSED ANGLE:  $+30^\circ$  (TOLERANCE FROM  $-4^\circ$  TO  $-10^\circ$ ) | OPENING ANGLE:  $105^\circ (\pm 3)$

### Features:

- For leaf thickness of 14-22 mm.
- $+30^\circ$  (tolerance from  $-4^\circ$  to  $-10^\circ$ ) angled hinge, opening angle  $105^\circ (\pm 3)$ , soft-close hinge.
- One-way hinge.
- Base material: Cold rolled steel cup & arm.
- Finishes: - Copper (CU) & nickel plated.  
- Optional: Copper (CU) & matt black plated.
- Tool-free (Clip-on) for easy assembly.
- Cup screw fixing distance: 48 mm.
- 3D adjustment (with mounting plate).
- Compliant to EN15570 - 40,000 cycles.

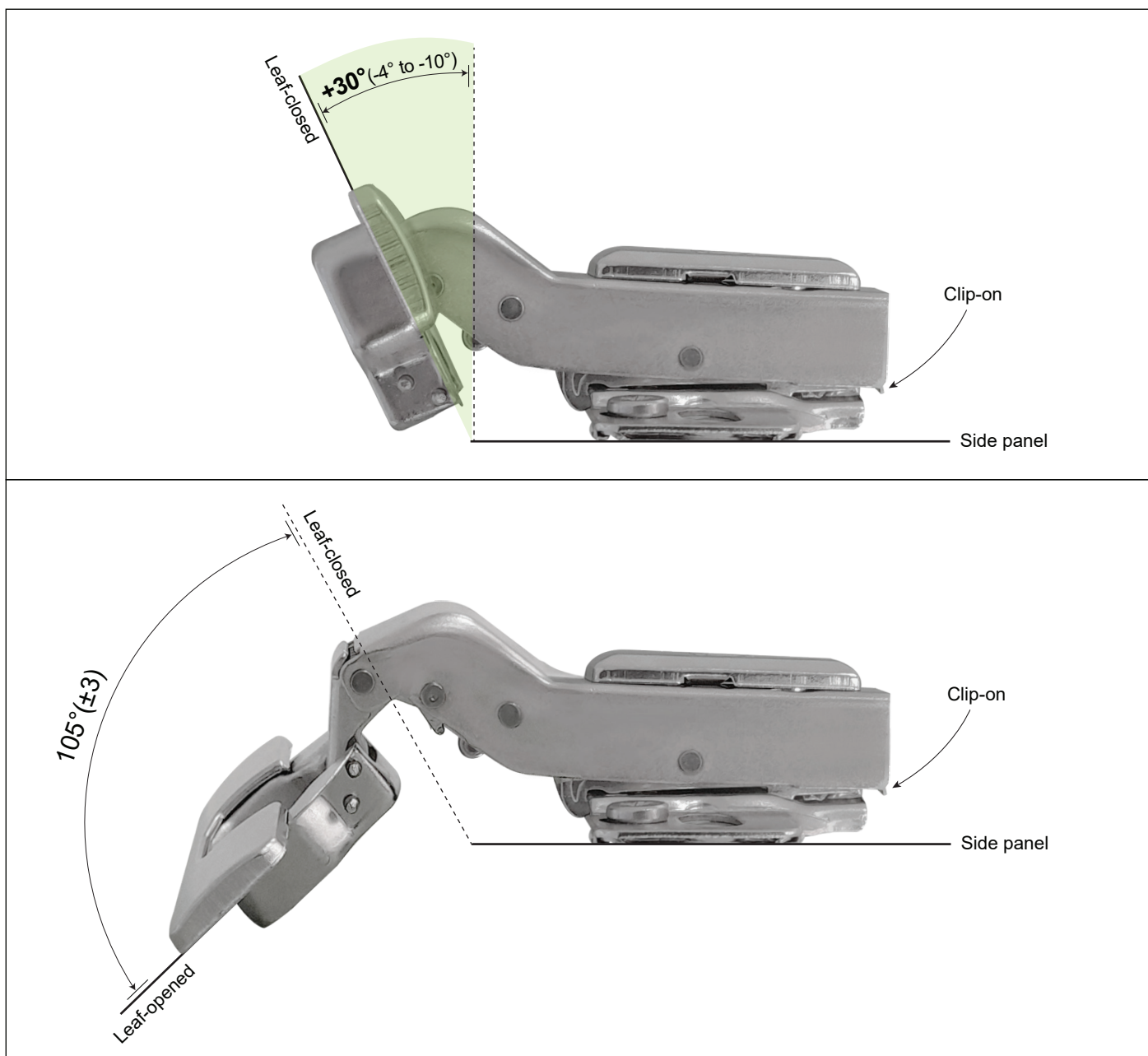
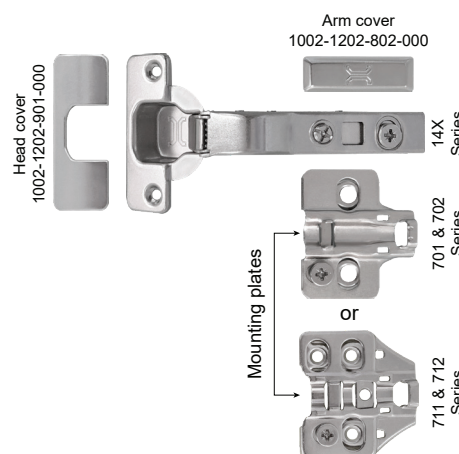

Cabinet hinge 14X Series with mounting plate 701 Series

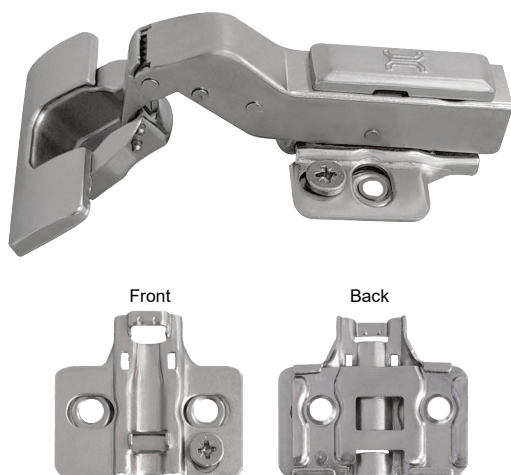

Cabinet hinge 14X Series with mounting plate 702 Series (with dowel)

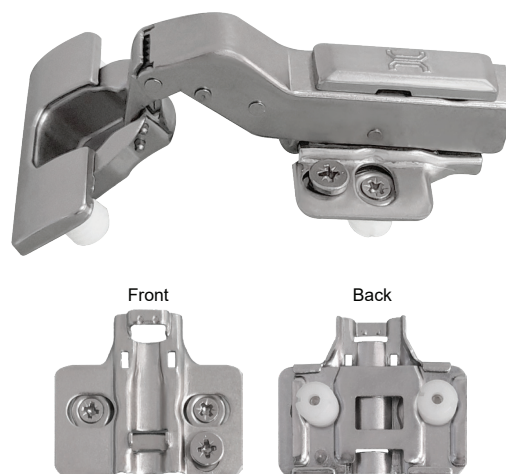

Cabinet hinge 14X Series with mounting plate 711 Series

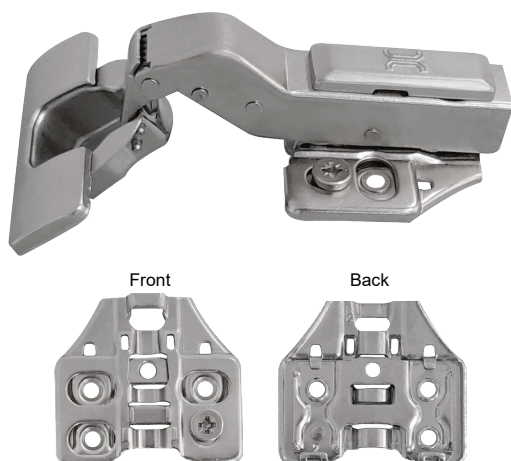

Cabinet hinge 14X Series with mounting plate 712 Series (with dowel)

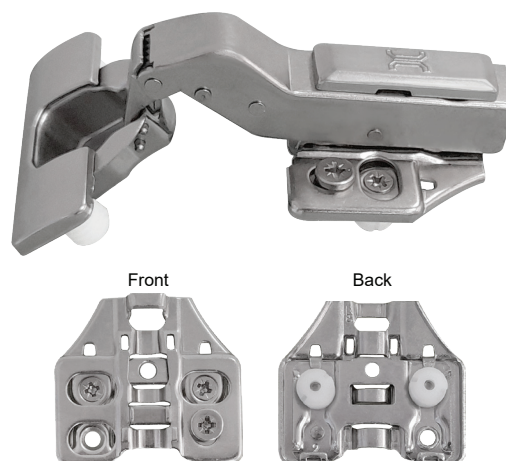

Dowel dimensions  
Ø 10 mm

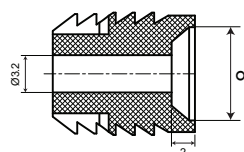
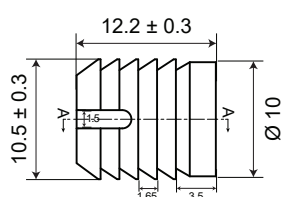

## Drilling pattern for cup fixing

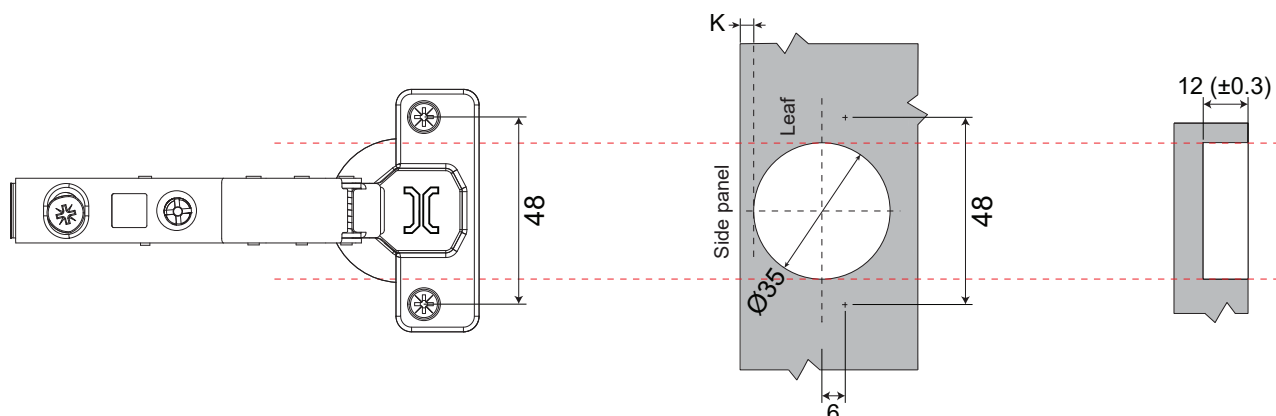

## Cup Installation

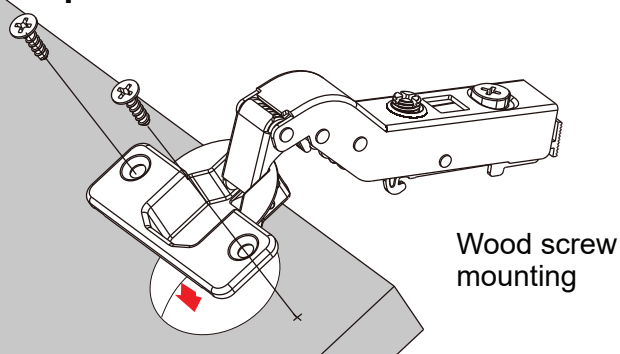

Wood screw  
mounting

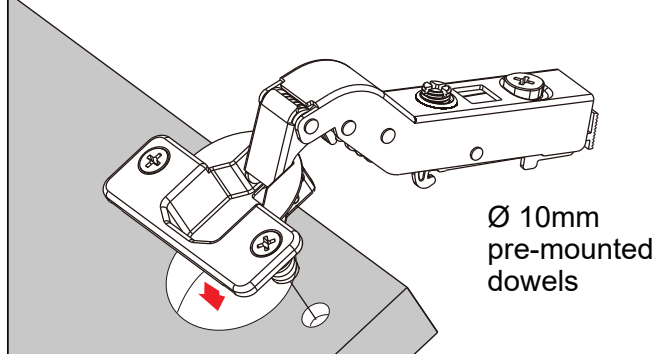

Ø 10mm  
pre-mounted  
dowels

### Mounting plates features:

- Wood screw: Ø 4\*15.5 mm.
- Fixing screw drilling space: 32 mm.
- To side panel edge: 34 mm to 37 mm.
- Adjustment range: -1.9 mm, +1.9 mm.
- Base material: Cold rolled steel.
- Finishes: - Copper (CU) & nickel plated.  
- Optional: Copper (CU) & matt black plated.
- Height:  
H0: 1002-1202-701-000 | 1002-1202-702-000 (with dowel)  
H2: 1002-1202-701-002 | 1002-1202-702-002 (with dowel)  
H4: 1002-1202-701-004 | 1002-1202-702-004 (with dowel)

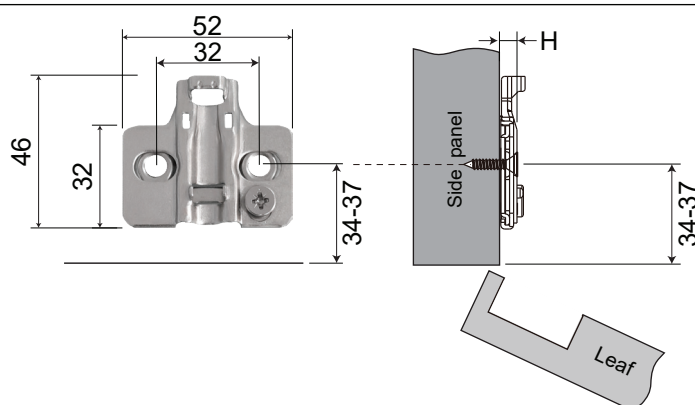

### Mounting plates features:

- Wood screw: Ø 4\*15.5 mm.
- Fixing screw drilling space: 32 mm.
- To side panel edge: 34 mm to 37 mm.
- Adjustment range: -1.9 mm, +1.9 mm.
- Base material: Cold rolled steel.
- Finishes: - Copper (CU) & nickel plated.  
- Optional: Copper (CU) & matt black plated.
- Height:  
H0: 1002-1202-711-000 | 1002-1202-712-000 (with dowel)  
H2: 1002-1202-711-002 | 1002-1202-712-002 (with dowel)  
H4: 1002-1202-711-004 | 1002-1202-712-004 (with dowel)

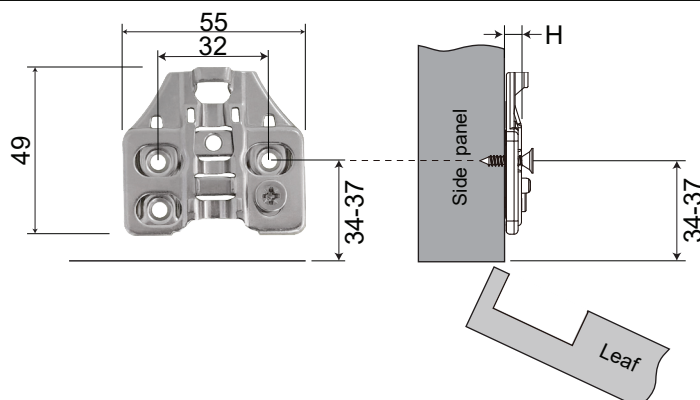

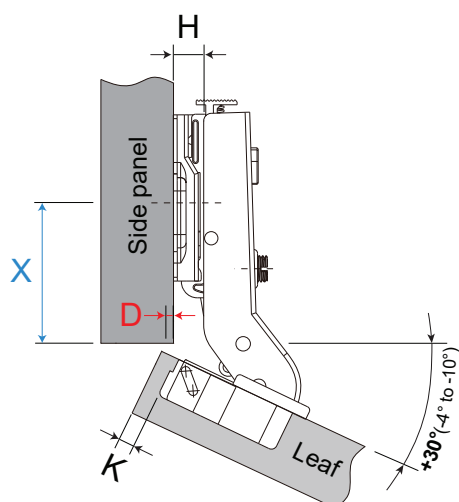

## FULL OVERLAY

Art #:1002-1202-140-030 &  
1002-1202-147-030 (with dowel)

X \ D	K	4	5	6	7
H					
0	37 3	36 4	35 5	34 6	
2	37 1	36 2	35 3	34 4	
4	37 -1	36 0	35 1	34 2	

## Hinge adjustment

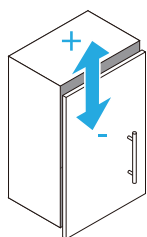

### Height adjustment

Adjust the mounting plate on panel to adjust the leaf's height.  
Adjust range: -1.9mm, +1.9mm.

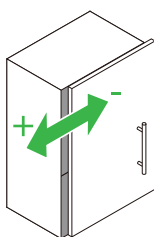

### Overlay adjustment

Rotate lateral screw to increase or decrease leaf overlay.  
Adjust range: -2.5mm, +2.5mm.

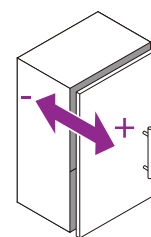

### Depth adjustment

Rotate depth screw to adjust leaf gap.  
Adjust range: -1.9mm, +1.9mm.

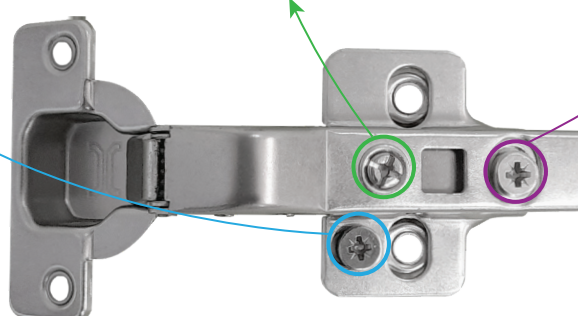

### Notes:

- Mounting plates 701 series, 702 series, 711 series & 712 series have the same adjustment ranges.
- The reference adjustment range is the product design range. The actual size of the cabinet and the drilling method may have a certain impact on the parameters.

## Hinges distribution based on leaf height and weight

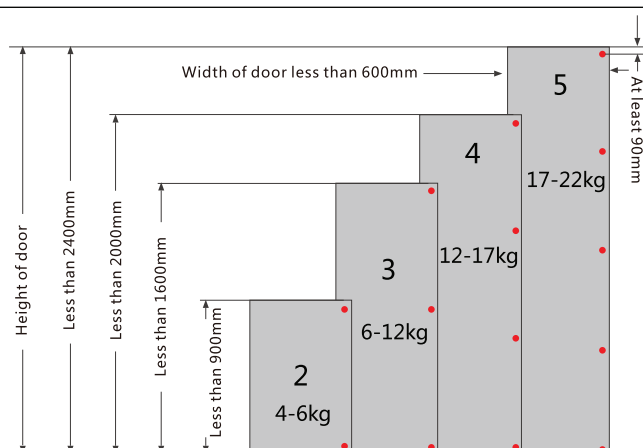

## Prototypes of hinge Installation

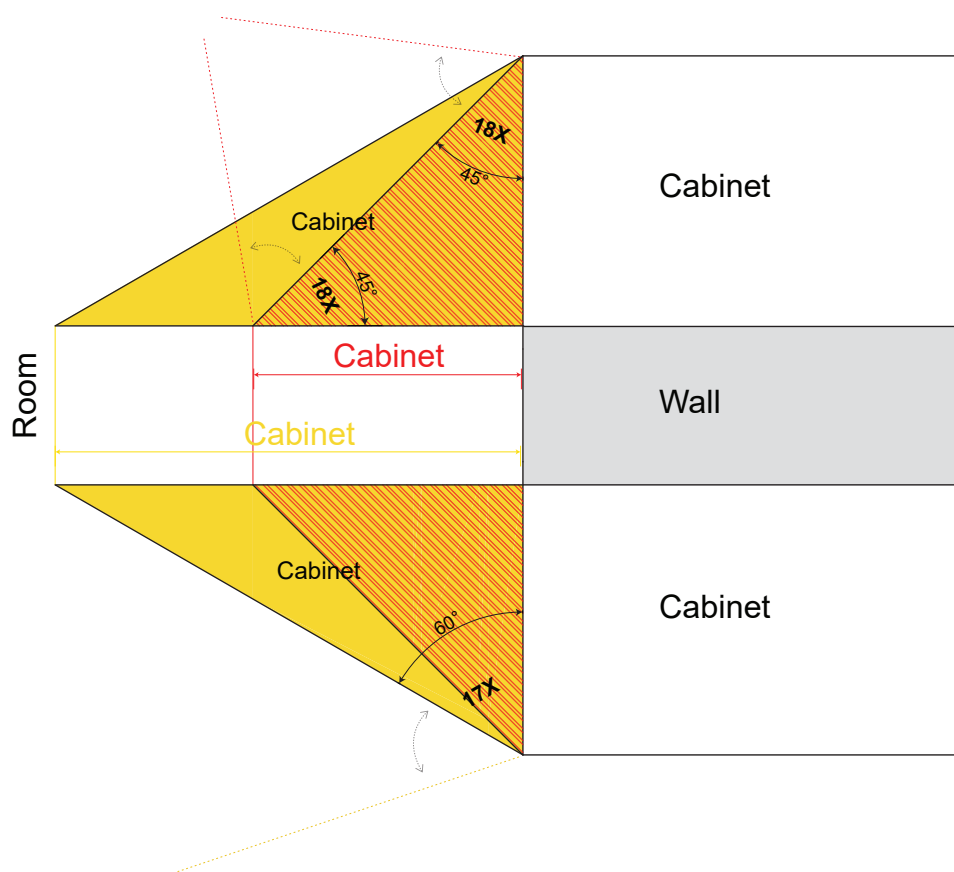
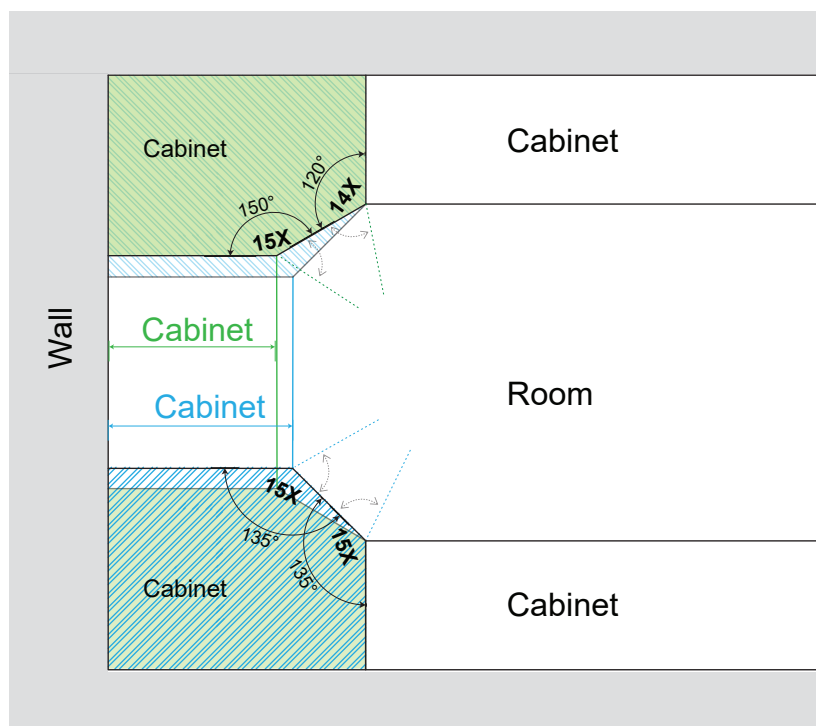

## Prototypes of hinge Installation

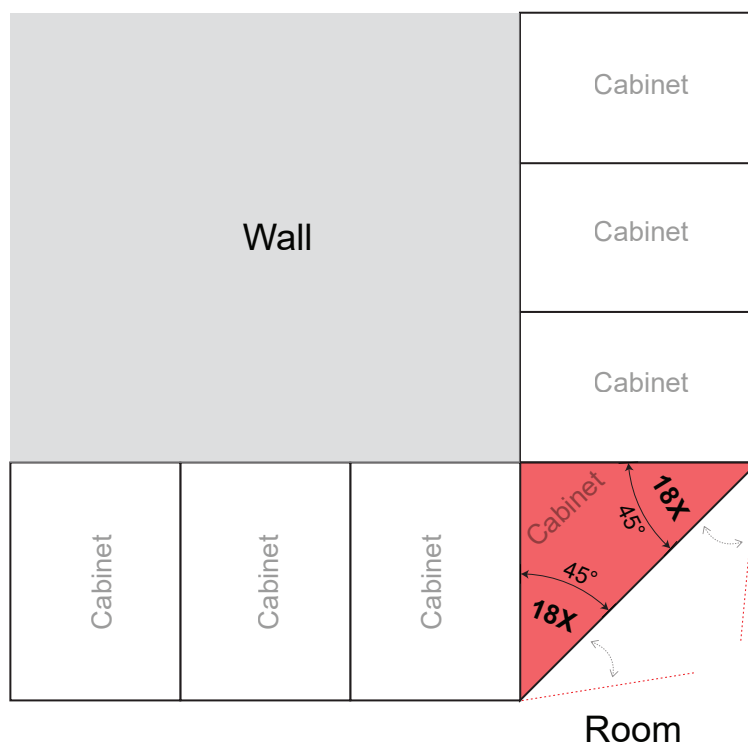
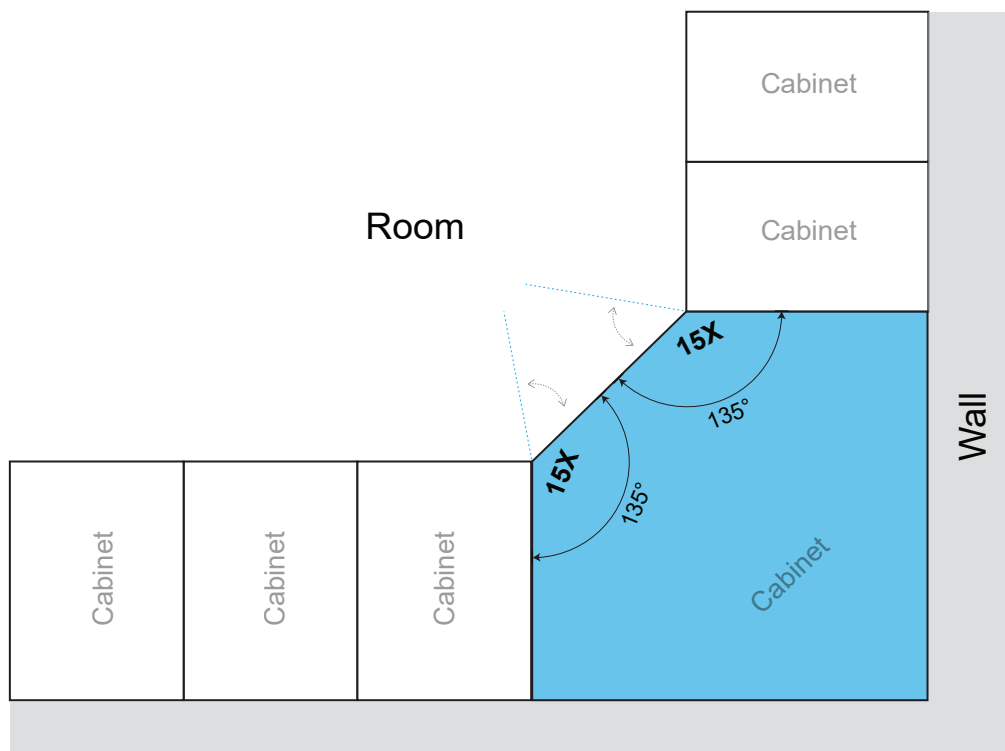

## Prototypes of hinge Installation

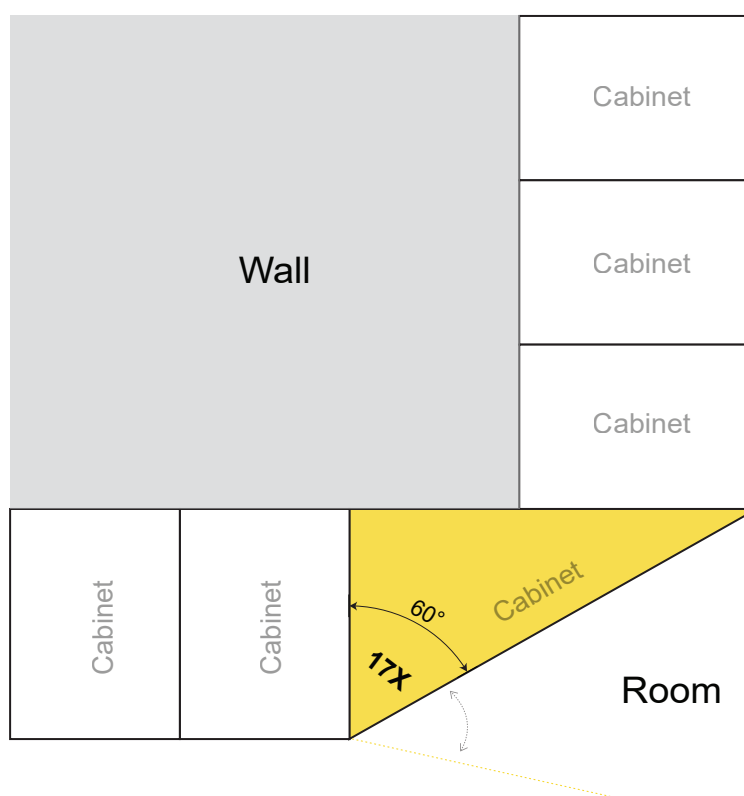
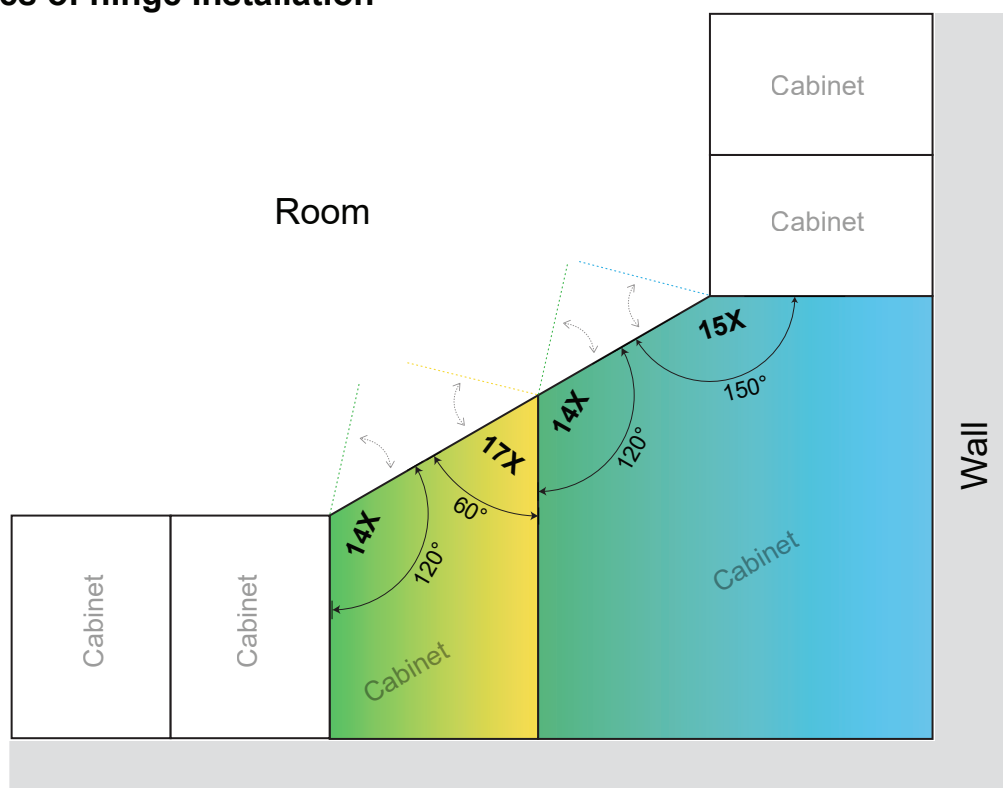

## Prototypes of hinge Installation

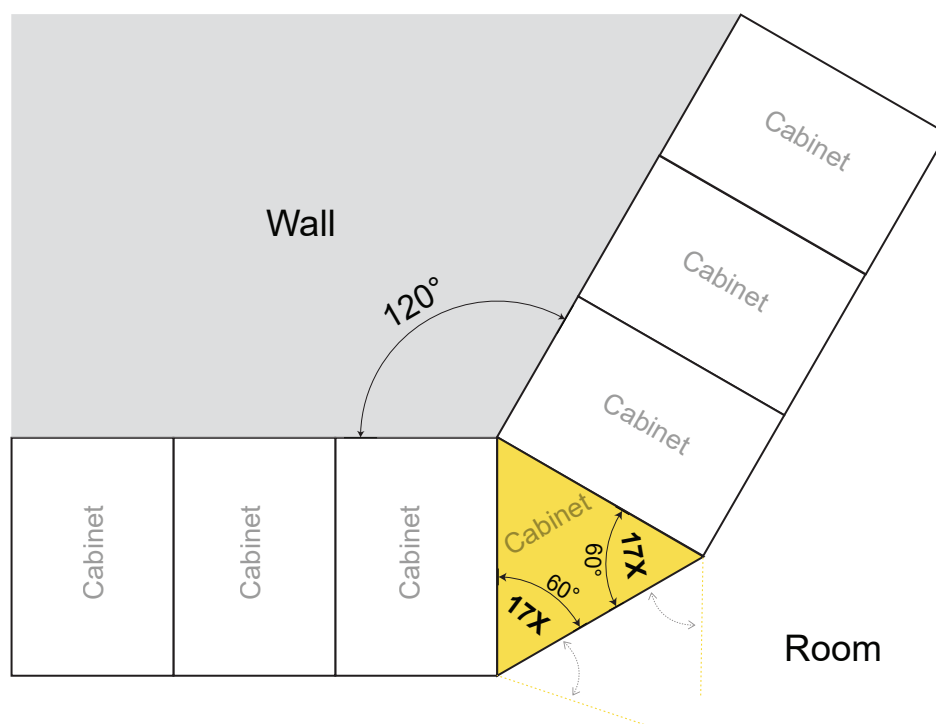
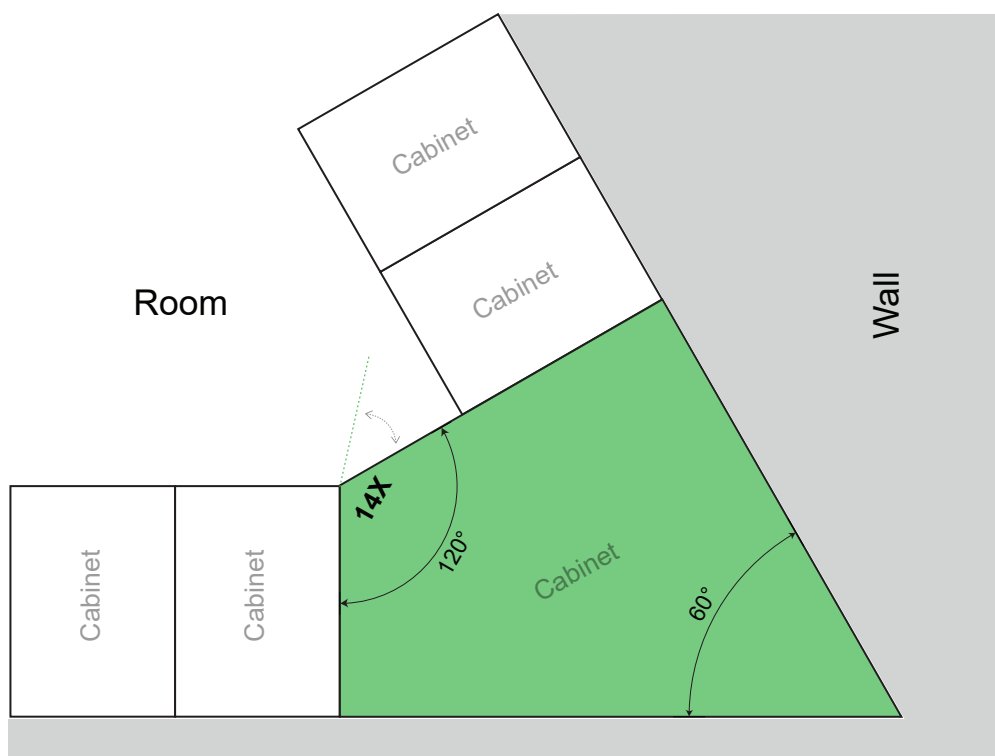



## Prototypes of hinge Installation

