

## ITEM CODE: 1002-1202-19X SERIES

CLIP-ON CABINET HINGE, OPENING ANGLE: 165° (TOLERANCE FROM -4° TO -10°)

### Features:

- For leaf thickness 14-26 mm.
- Opening angle **165°**(tolerance from -4° to -10°), soft-close hinge.
- One-way hinge.
- Soft closing starts as early as 10° opening angle.
- Base material: Cold rolled steel cup & arm.
- Finishes: - Copper (CU) & nickel plated.  
- Optional: Copper (CU) & matt black plated.
- Tool-free (Clip-on) for easy assembly.
- Cup screw fixing distance: 48 mm.
- 3D adjustment (with mounting plate).
- Compliant to EN15570 - 40,000 cycles.

Illustrated hinge 19X Series with mounting plate 701 & 702 Series

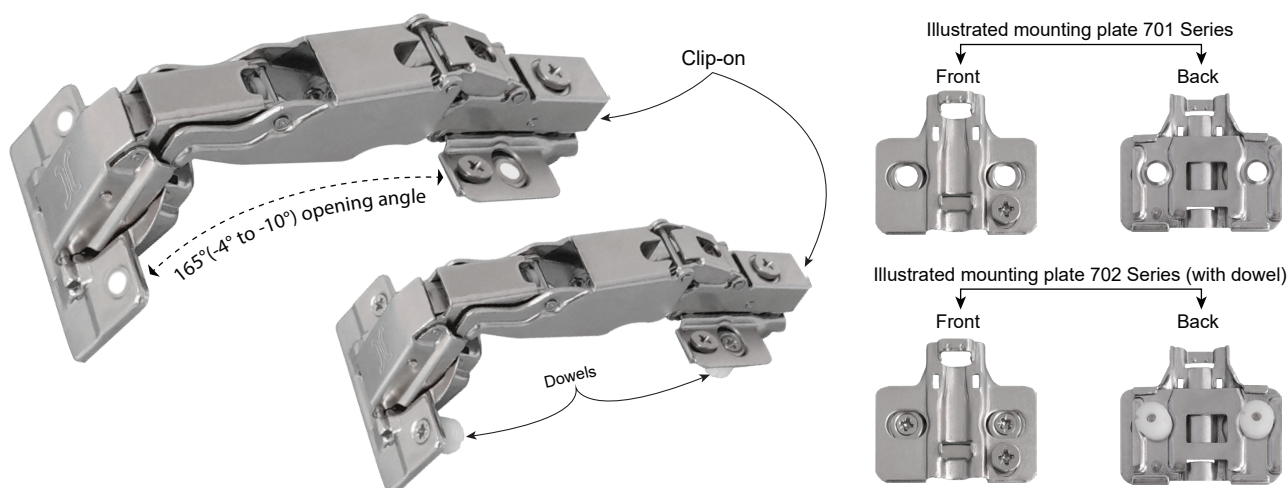

Illustrated hinge 19X Series with mounting plate 711 & 712 Series

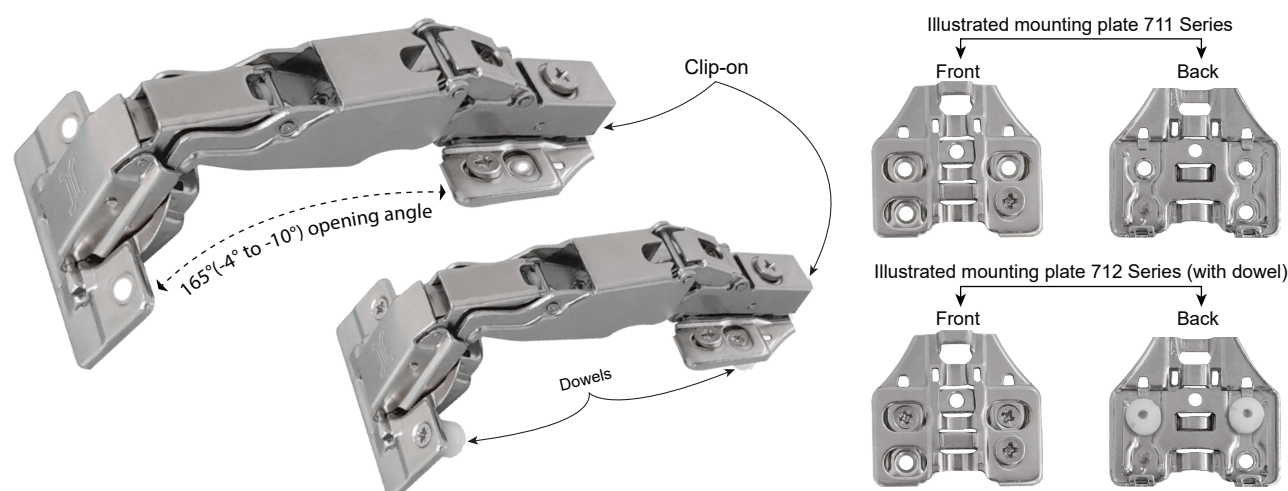

Dowel dimensions  
Ø 10 mm

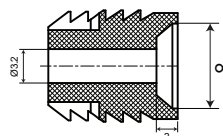
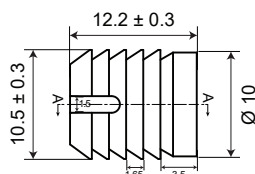

**Diagram for cup fixing**

The diagram illustrates the dimensions for the cup fixing assembly. It includes three views: a side view of the assembly, a top view of the side panel, and a side view of the leaf. The side panel has a circular hole with diameter  $\text{Ø}35$  and a width of 48. The leaf has a width of 12 ( $\pm 0.3$ ). The side panel is labeled "Side panel" and the leaf is labeled "Leaf". The distance between the center of the hole and the edge of the side panel is 48. The distance between the center of the hole and the edge of the leaf is 48. The distance between the center of the hole and the edge of the side panel is 48. The distance between the center of the hole and the edge of the leaf is 48.

Wood screw mounting

## Wood screw mounting

Ø 10mm  
pre-mounted  
dowels

Side panel

3

Leaf

22

Illustrated 165°(-4° to -10°) opening angle hinge  
with mounting plate H0

- Wood screw: Ø 4\*15.5 mm.
- Fixing screw drilling space: 32 mm.
- To side panel edge: 34 mm to 37 mm (for full & half overlay).
- Adjustment range: -1.9 mm, +1.9 mm.
- Base material: Cold rolled steel.
- Finishes: - Copper (CU) & nickel plated.  
- Optional: Copper (CU) & matt black plated.
- Height:
 

H0: 1002-1202-701-000		1002-1202-702-000 (with dowel)
H2: 1002-1202-701-002		1002-1202-702-002 (with dowel)
H4: 1002-1202-701-004		1002-1202-702-004 (with dowel)

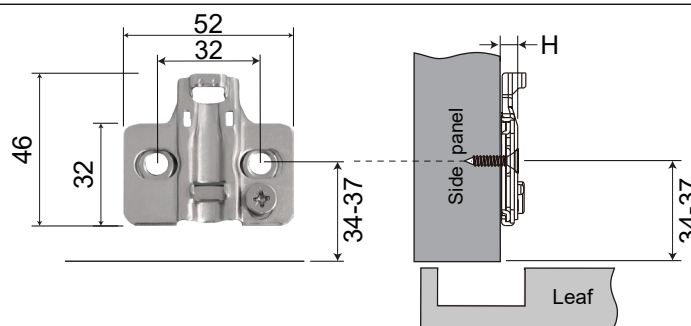

- Wood screw: Ø 4\*15.5 mm.
- Fixing screw drilling space: 32 mm.
- To side panel edge: 34 mm to 37 mm (for full & half overlay).
- Adjustment range: -1.9 mm, +1.9 mm.
- Base material: Cold rolled steel.
- Finishes: - Copper (CU) & nickel plated.  
- Optional: Copper (CU) & matt black plated.
- Height:
 

H0: 1002-1202-711-000		1002-1202-712-000 (with dowel)
H2: 1002-1202-711-002		1002-1202-712-002 (with dowel)
H4: 1002-1202-711-004		1002-1202-712-004 (with dowel)

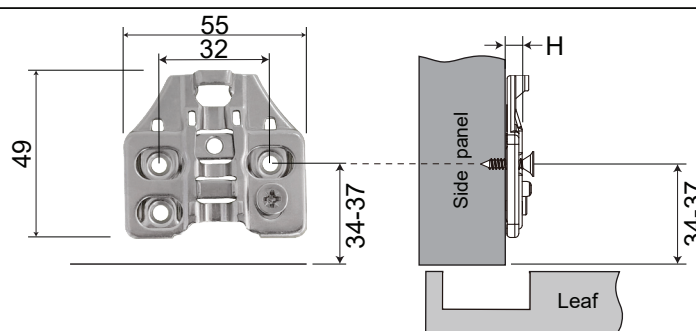

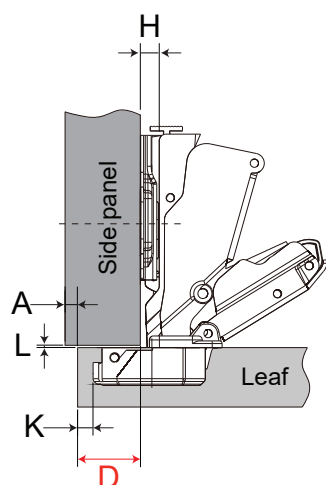

## FULL OVERLAY

Art #: 1002-1202-191-165 &  
1002-1202-194-165 (with dowel)

$$H = 14 + K - D$$

D \ K	3	4	5	6	7
0	17	18	19	20	21
2	15	16	17	18	19
4	13	14	15	16	17

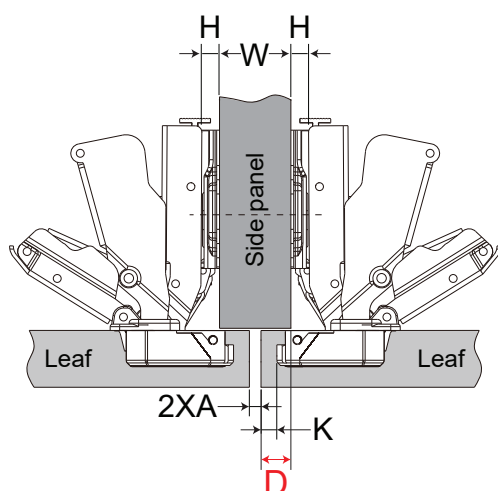

## HALF OVERLAY

Art #: 1002-1202-192-165 &  
1002-1202-195-165 (with dowel)

$$H = 4 + K - D$$

D \ K	3	4	5	6	7
0	7	8	9	10	11
2	5	6	7	8	9
4	3	4	5	6	7

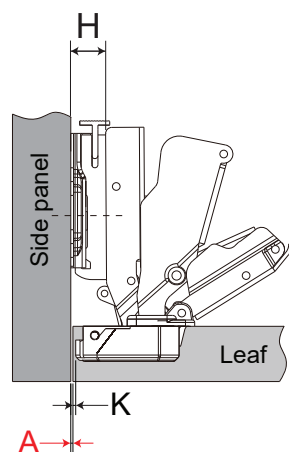

## INSET

Art #: 1002-1202-193-165 &  
1002-1202-196-165 (with dowel)

$$H = 0 + K + A$$

A \ K	3	4	5	6	7
2	-1	-2	-3	-4	-5
4	1	0	-1	-2	-3

## Minimum reveal table

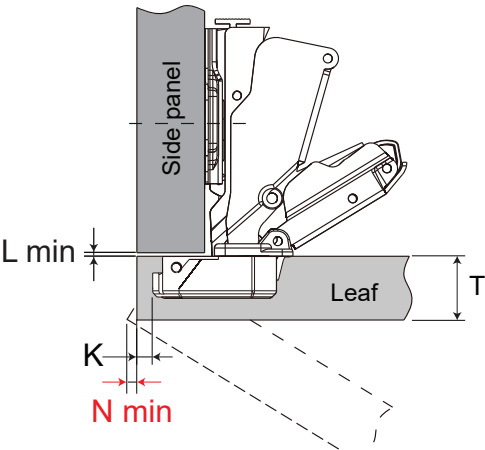

N	K	T	14	15	16	17	18	19	20	21	22	23	24	25	26
3	0.0	0.0	0.0	0.0	0.0	0.0	0.0	0.0	0.0	0.0	0.5	1.0	1.6	2.1	2.7
4	0.0	0.0	0.0	0.0	0.0	0.0	0.0	0.0	0.0	0.0	0.3	0.9	1.4	2.0	2.5
5	0.0	0.0	0.0	0.0	0.0	0.0	0.0	0.0	0.0	0.0	0.1	0.7	1.2	1.8	2.3
6	0.0	0.0	0.0	0.0	0.0	0.0	0.0	0.0	0.0	0.0	0.0	0.5	1.1	1.6	2.2
7	0.0	0.0	0.0	0.0	0.0	0.0	0.0	0.0	0.0	0.0	0.0	0.4	0.9	1.5	2.0

K= Boring distance  
T= Leaf thickness  
N= Minimum gap  
L= Gap between leaf & side panel

*Note: Parameters (showing on tables) are based on right-angle leaf edge. If the leaves having round corner edges, the parameters value will be reduced.*

## Hinge adjustment

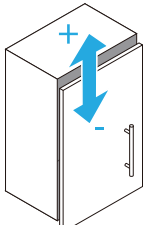

**Height adjustment**

Adjust the mounting plate on panel to adjust the leaf's height.  
Adjust range: -1.9mm, +1.9mm.

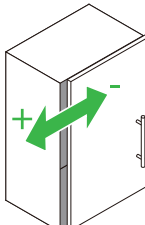

**Overlay adjustment**

Rotate lateral screw to increase or decrease leaf overlay.  
Adjust range: -3mm, +3mm.

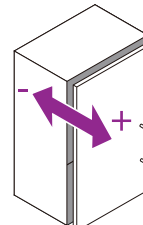

**Depth adjustment**

Rotate depth screw to adjust leaf gap.  
Adjust range: -1.9mm, +1.9mm.

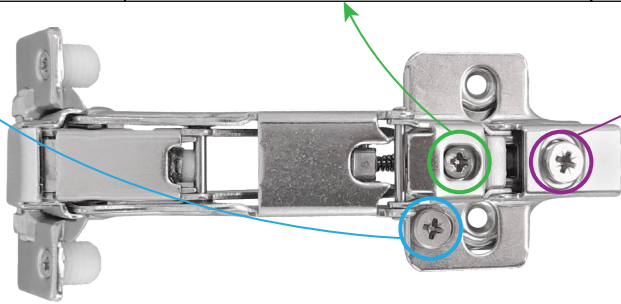

**Notes:**

- Mounting plates 701 series, 702 series, 711 series & 712 series have the same adjust ranges.
- The reference adjustment range is the product design range. The actual size of the cabinet and the drilling method may have a certain impact on the parameters.

## Hinges distribution based on leaf height and weight

