

ITEM CODE: 1002-1202-21X SERIES

CLIP-ON CABINET HINGE, OPENING ANGLE: 155° (TOLERANCE FROM 0° TO -6°)

Features:

- For leaf thickness 14-28 mm.
- Opening angle 155° (tolerance from 0° to -6°), soft-close hinge.
- One-way hinge.
- Soft closing starts as early as 5° opening angle.
- Base material: Cold rolled steel cup & arm.
- Spiral screw provides easy & infinitely variable depth adjustment.
- Finishes: - Copper (CU) & nickel plated.
- Optional: Copper (CU) & matt black plated.
- Tool-free (Clip-on) for easy assembly.
- Cup screw fixing distance: 48 mm.
- 3D adjustment (with mounting plate).
- Allows for the most access into the cabinet.
- Zero protrusion on full overlay with max. 2 mm mounting plates.
- Compliant to EN15570 - 40,000 cycles.

Illustrated hinge 21X Series with mounting plate 701 & 702 Series

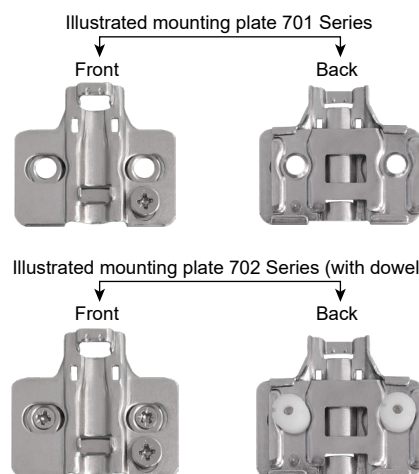
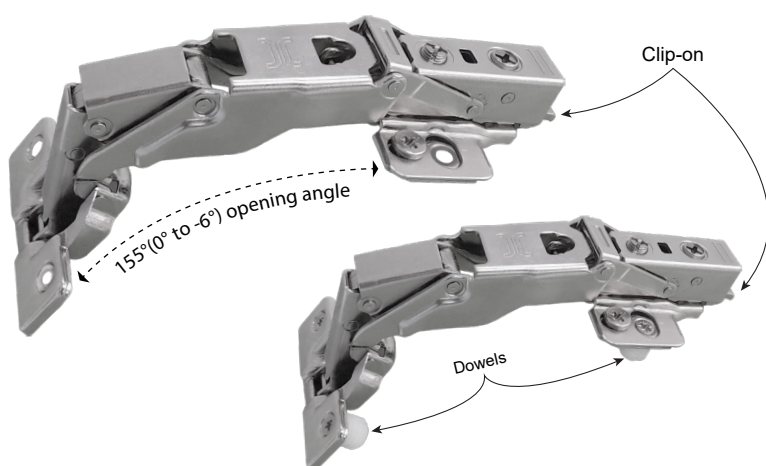

Illustrated hinge 21X Series with mounting plate 711 & 712 Series

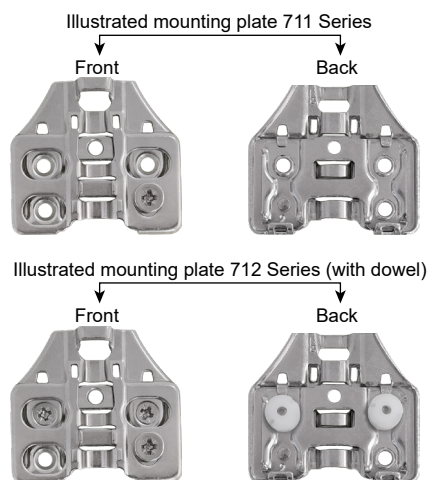
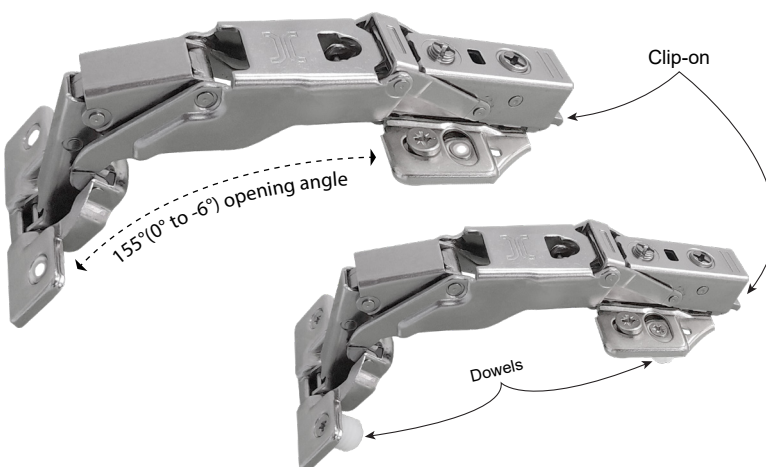

Dowel dimensions
Ø 10 mm

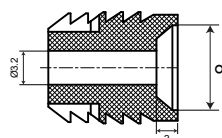
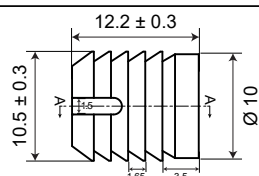

Drilling pattern for cup fixing

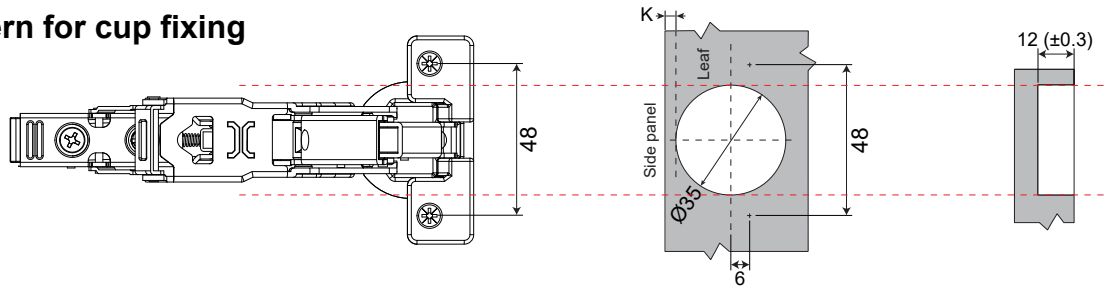

Cup Installation

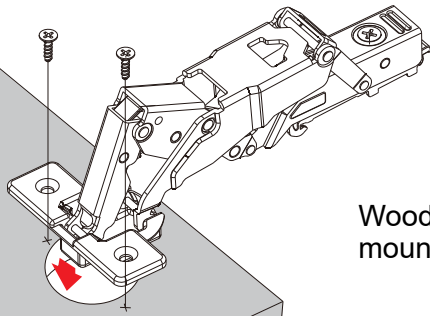

Wood screw
mounting

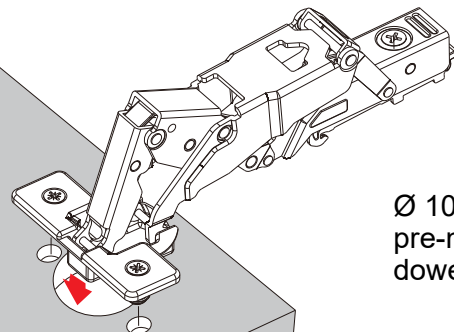

Ø 10mm
pre-mounted
dowels

Illustrated 90° opening angle hinge
with mounting plate H0

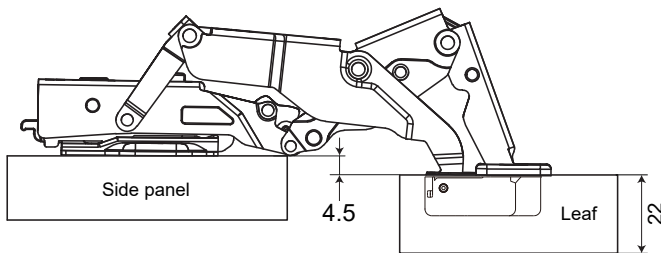

Illustrated 155°(0° to -6°) opening
angle hinge with mounting plate H0

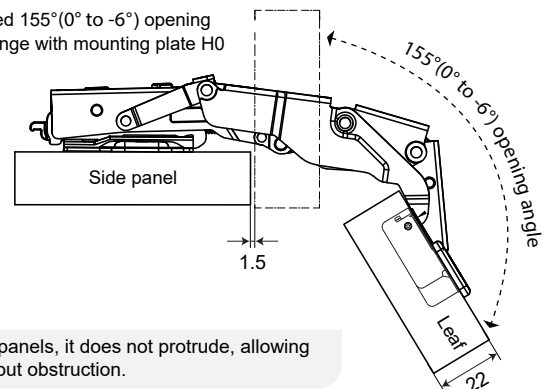

Zero Protrusion: When the leaf is opened parallel to the side panels, it does not protrude, allowing access to any pull baskets or drawers inside the cabinet without obstruction.

Mounting plates features:

- Wood screw: Ø 4*15.5 mm.
- Fixing screw drilling space: 32 mm.
- To side panel edge: 34 mm to 37 mm (for full & half overlay).
- Adjustment range: -1.9 mm, +1.9 mm.
- Base material: Cold rolled steel.
- Finishes: - Copper (CU) & nickel plated.
- Optional: Copper (CU) & matt black plated.
- Height:

H0: 1002-1202-701-000	1002-1202-702-000 (with dowel)
H2: 1002-1202-701-002	1002-1202-702-002 (with dowel)
H4: 1002-1202-701-004	1002-1202-702-004 (with dowel)

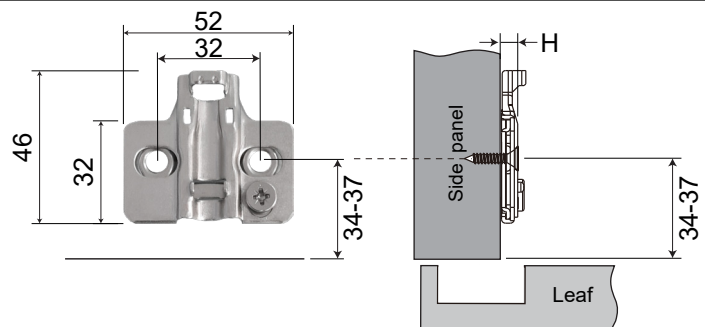

Mounting plates features:

- Wood screw: Ø 4*15.5 mm.
- Fixing screw drilling space: 32 mm.
- To side panel edge: 34 mm to 37 mm (for full & half overlay).
- Adjustment range: -1.9 mm, +1.9 mm.
- Base material: Cold rolled steel.
- Finishes: - Copper (CU) & nickel plated.
- Optional: Copper (CU) & matt black plated.
- Height:

H0: 1002-1202-711-000	1002-1202-712-000 (with dowel)
H2: 1002-1202-711-002	1002-1202-712-002 (with dowel)
H4: 1002-1202-711-004	1002-1202-712-004 (with dowel)

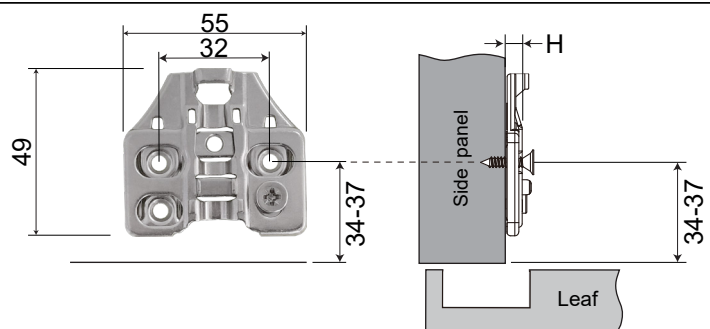

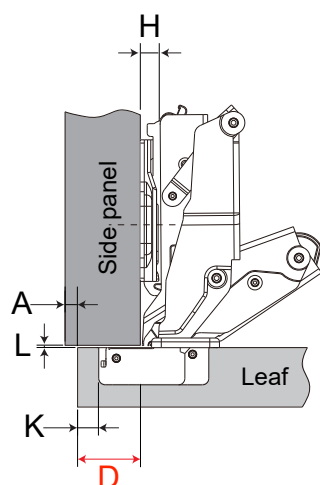

FULL OVERLAY

Art #:1002-1202-211-155 &
1002-1202-214-155 (with dowel)

$$H = 14 + K - D$$

D \ K	3	4	5	6	7
0	17	18	19	20	21
2	15	16	17	18	19
4	13	14	15	16	17

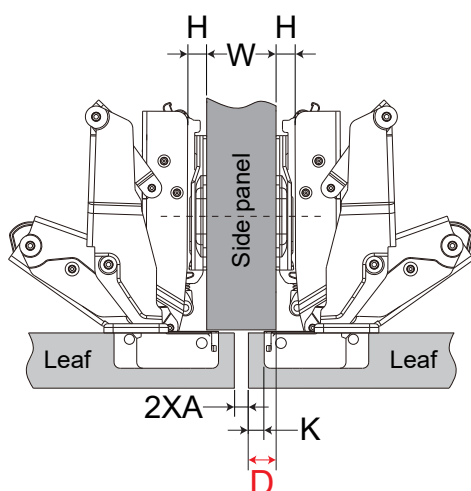

HALF OVERLAY

Art #:1002-1202-212-155 &
1002-1202-215-155 (with dowel)

$$H = 4 + K - D$$

D \ K	3	4	5	6	7
0	7	8	9	10	11
2	5	6	7	8	9
4	3	4	5	6	7

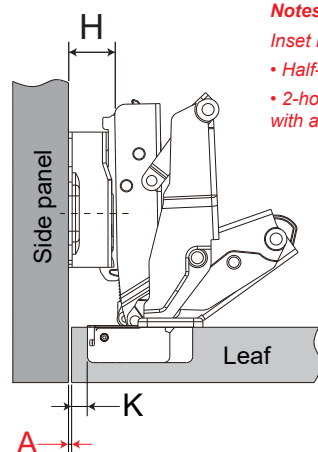

INSET

Notes:

Inset hinge requires:

• Half-overlay hinge.

• 2-hole mounting plate
with a height of 9 (H9).

Art #:1002-1202-212-155 &
1002-1202-215-155 (with dowel)

with mounting plate:

Art #: 1002-1202-741-009 &
1002-1202-742-009 (with dowel)

$$H = 0 + K + A$$

A \ K	3	4	5	6	7
9	1	0	-1	-2	-3

Minimum reveal table

The diagram illustrates the assembly of a window mechanism. A side panel is shown on the left, and a leaf is on the right. The leaf has a thickness labeled 'T'. The gap between the leaf and the side panel is labeled 'L min'. The boring distance is labeled 'K'. The minimum gap is labeled 'N min'.

N	T	14	15	16	17	18	19	20	21	22	23	24	25	26	27	28
K																
3		0.0	0.0	0.0	0.0	0.0	0.0	0.0	0.0	0.3	0.7	1.1	1.5	2.0	2.5	3.0
4		0.0	0.0	0.0	0.0	0.0	0.0	0.0	0.0	0.3	0.8	1.3	1.8	2.3	2.9	3.5
5		0.0	0.0	0.0	0.0	0.0	0.0	0.0	0.0	0.4	1.0	1.5	2.1	2.7	3.5	4.4
6		0.0	0.0	0.0	0.0	0.0	0.0	0.0	0.0	0.6	1.2	1.9	2.6	3.5	4.8	5.5
7		0.0	0.0	0.0	0.0	0.0	0.0	0.5	1.1	1.8	2.6	3.5	4.7	5.6	6.7	7.6

K= Boring distance

T= Leaf thickness

N= Minimum gap

L= Gap between leaf & side panel

Note: Parameters (showing on tables) are based on right-angle leaf edge. If the leaves having round corner edges, the parameters value will be reduced.

Hinge adjustment

Height adjustment

Adjust the mounting plate on panel to adjust the leaf's height.
Adjust range: -1.9mm, +1.9mm.

Overlay adjustment

Rotate lateral screw to increase or decrease leaf overlay.
Adjust range: -3mm, +3mm.

Depth adjustment

Rotate depth screw to adjust leaf gap.
Adjust range: -3mm, +3mm.

Notes:

- Mounting plates 701 series, 702 series, 711 series & 712 series have the same adjustment ranges.
- The reference adjustment range is the product design range. The actual size of the cabinet and the drilling method may have a certain impact on the parameters.

Hinges distribution based on leaf height and weight

